

25625 M16 Vacuum Valve II (with Pushbutton Release)

Instruction Manual

FOREWORD

Thank you for your purchase of a NAUTICAM product.

At NAUTICAM, we pride ourselves in the ability to recognize the requirements of professional as well as amateur underwater photographers and fulfill them through the innovative designs of our products. We strive to achieve a high level of user-friendliness by allowing stress-free installation and easy operation of all important functions of the camera.

Each product is individually inspected and water pressure tested to ensure optimum quality.

Please read this manual carefully before using the product, this will maximize its performance as well as its lifetime.

WARRANTY

All NAUTICAM Products are warranted against any material and manufacturing defects for two years from the date of purchase for consumer use. This warranty only applies to products purchased from authorized NAUTICAM dealers and does not extend beyond the original retail purchaser.

To return your product for service, please contact your regional authorized service center(s). Please note that this warranty only applies when the product is purchased in the territory where the service center is located.

NAUTICAM does not hold responsibility for damage, of any nature, to any equipment used with and/or placed within our products.

NAUTICAM accepts no liability for any loss of captured images or the inability to capture images even if it is due to the malfunctioning of our products.

Unauthorized modifications and/or repairs of our products will automatically invalidate the warranty.

IDENTIFICATION OF PARTS

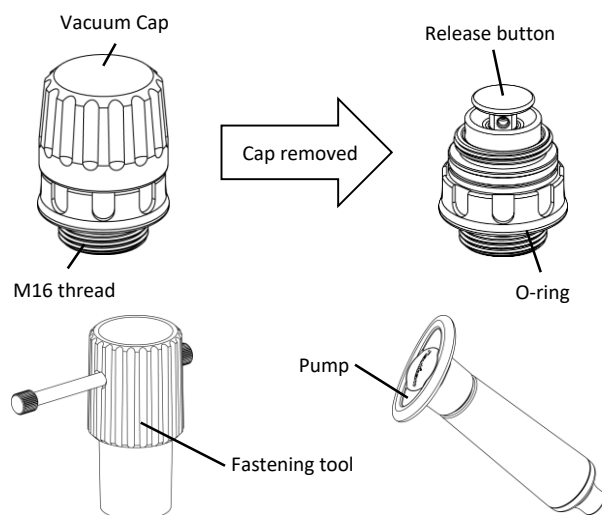

BUILDING UP VACUUM

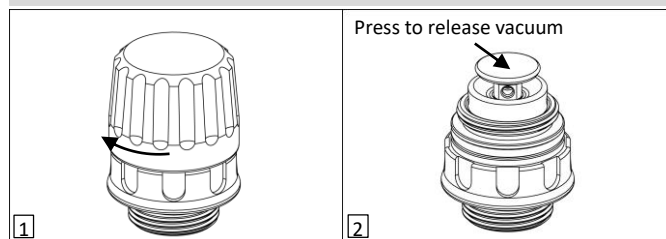

Remove the cap of the vacuum valve. Connect the hand pump to the valve and pump several times until it reaches the target vacuum level. The LED light will turn flashing yellow while vacuum is building up, then steady green when the target vacuum level is reached.

Attention: After the target vacuum is reached, i.e. steady green light, attach the cap back to the vacuum valve.

It is recommended to leave the housing for at least 20mins to ensure it is sealed. If the LED light changes from steady green light to rapidly flashing yellow light, that means there is a leakage and please check every O-ring and conduct the vacuum test again.

Please ensure that the cap is attached back to the vacuum valve before going underwater.

Vacuum can be released by pushing the red release button.

Attention: Please DO NOT attempt to go over the designated vacuum level, i.e. stop pumping when the LED turn green. Excessive vacuum level may lead to the malfunction of the camera and lens.

Note: Although the vacuum indicator is designed to compensate for a certain amount of temperature variation, it is recommended to conduct the vacuum test in an environment where the temperature is stable.

SPECIFICATIONS

Dimensions:	Dia23.5mm x 32mm
Weight:	Approx. 24.3g
Depth Rating:	150m
Thread size:	M16

INSTALL THE VALVE

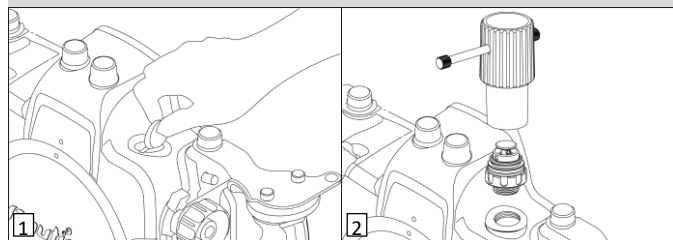

Remove the plug of the M16 accessory port from the housing. Remove the cap from the vacuum valve. Tighten the vacuum valve to the housing with the tool provided.

Note: Slightly lubricate the O-ring with Nauticam lubricant. Ensure that the o-ring is properly seated in it's groove at the base of the vacuum valve.