

Olympus M.Zuiko 12-50mm F3.5-6.3 EZ zoom gear

Underwater Lens Zoom Gear

Identification of parts:

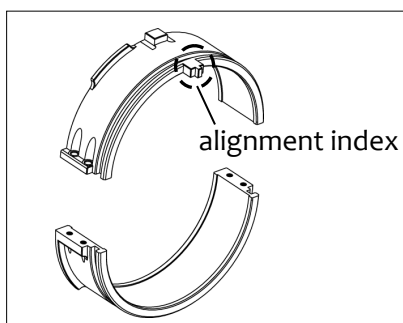

Two half-rings - Zoom Gear

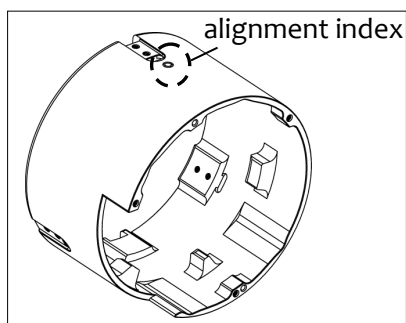

Zoom gear tube - Zoom Gear

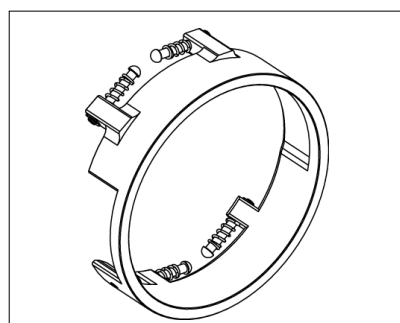

Spring ring - Zoom gear

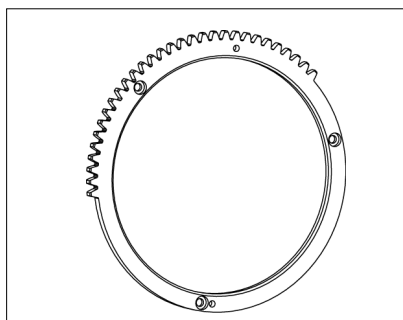

Zoom gear ring - Zoom Gear
#90166

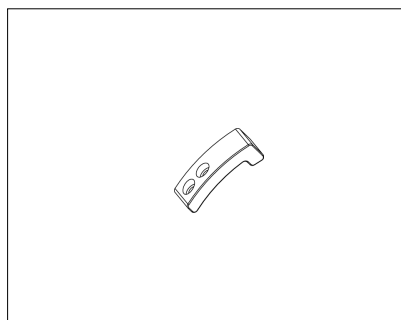

Macro Switch Block - Zoom
Gear

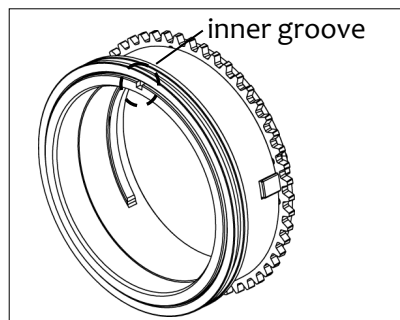

Macro switch gear

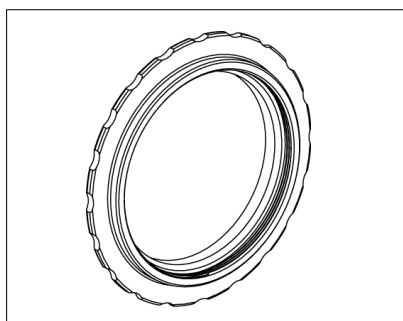

Locking ring - Macro switch
Gear

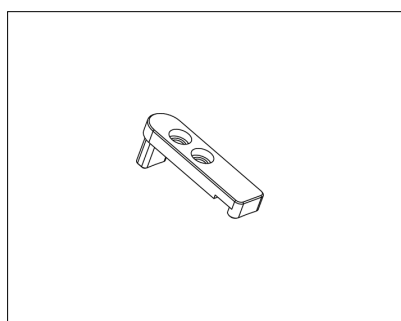

Positioning Block x3- Macro
Switch Gear

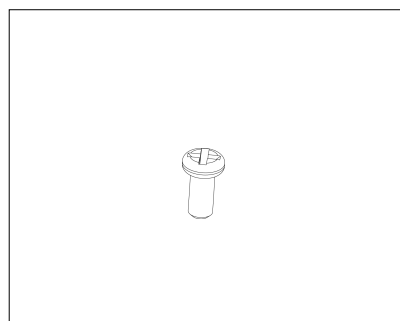

Screw x12

Olympus M.Zuiko 12-50mm F3.5-6.3 EZ zoom gear

Underwater Lens Zoom Gear

Please follow the instructions below to mount the dedicated zoom gear on the lens.

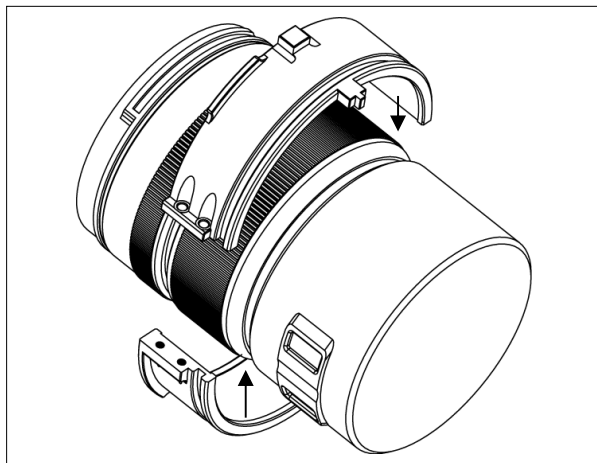

1. Mount the two half-rings on the lens zoom ring as indicated in the diagram.

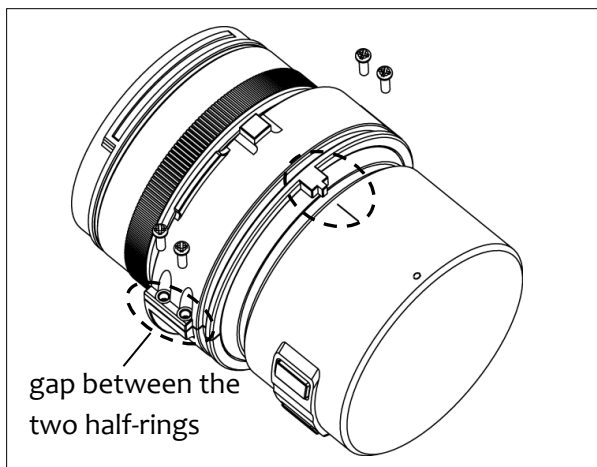

2. Align the alignment index on the ring with the line on the lens before tightening the four screws. While tightening the screws, make sure that the gaps on both sides are even and the ring does not slip when turning at E-ZOOM mode.

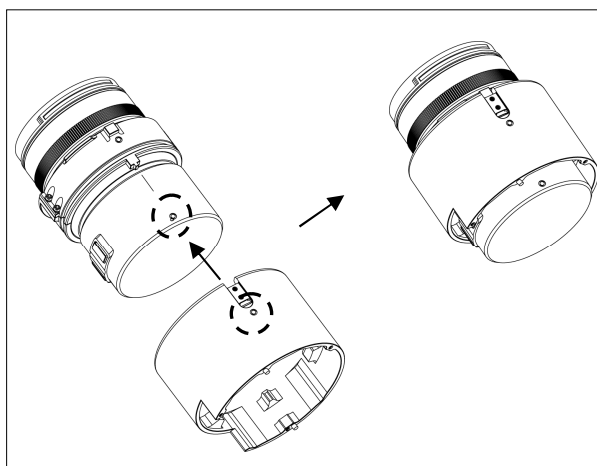

3. Align the alignment index on zoom gear tube with the red dot on the lens and insert the tube onto the lens.

Olympus M.Zuiko 12-50mm F3.5-6.3 EZ zoom gear

Underwater Lens Zoom Gear

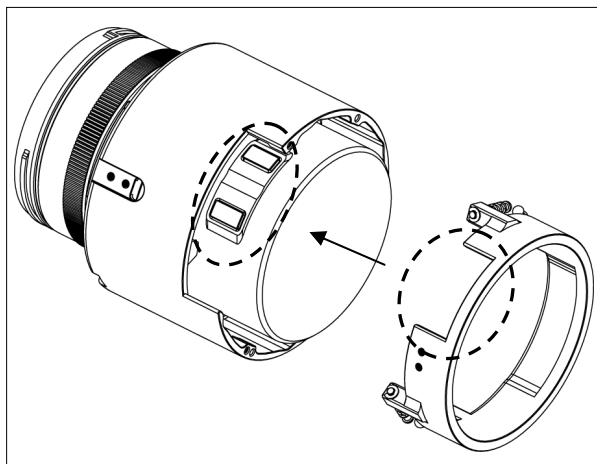

4. Align the spring ring with the lens as indicated in the diagram. Then lightly push the ring towards the lens until it cannot go any further.

Tip: To remove, pull out from the cover.

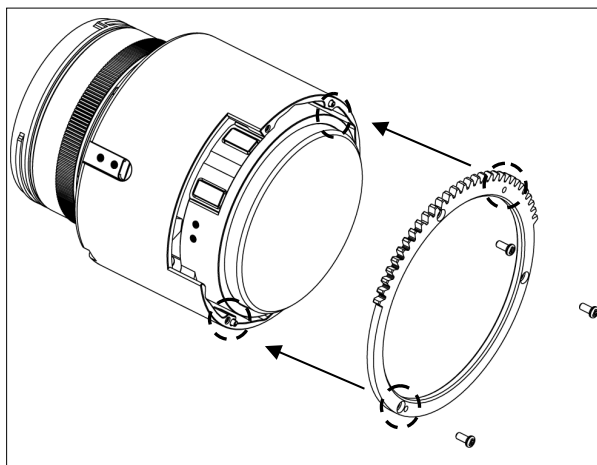

5. Align the pins on the tube with the holes in the gear ring as indicated in the diagram. Then tighten the three screws.

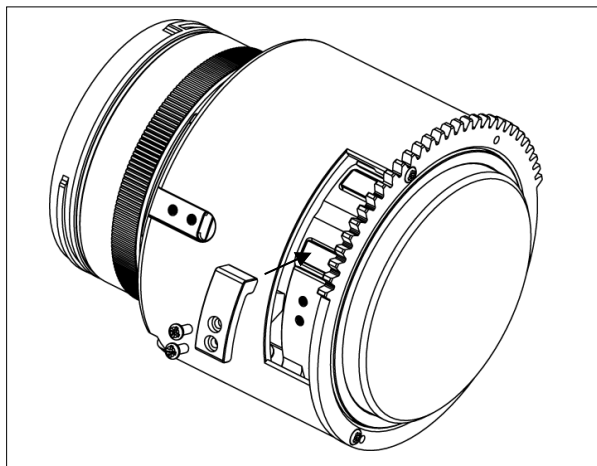

6. Align and tighten the screws with the Macro switch block pressing on the lens MACRO button.

Olympus M.Zuiko 12-50mm F3.5-6.3 EZ zoom gear

Underwater Lens Zoom Gear

The Macro switch gear will be mounted from the front of the lens.

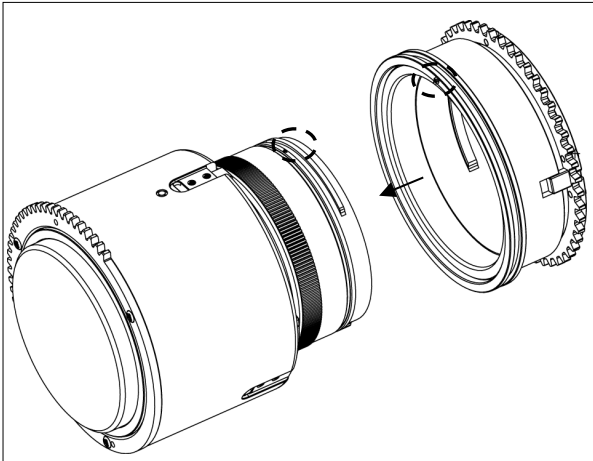

7. Align the inner groove of the macro switch gear with the white dot on the front part of the lens. Then lightly push the gear towards the lens until it cannot go any further.

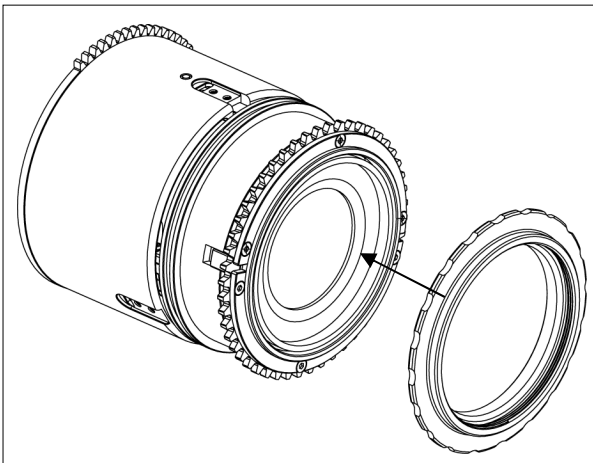

8. Tighten the macro switch gear by screwing the locking ring into the thread on the front of the lens.

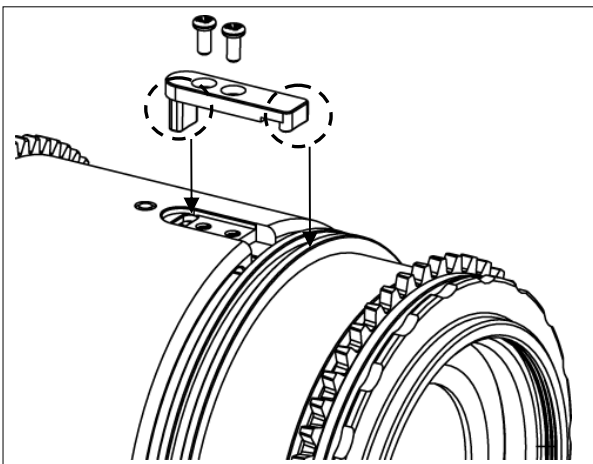

9. Align the positioning block onto the two gears. With the longer ends inserted into the hole of the zoom gear and the shorter ends sat into the groove of the macro switch gear. Then tighten the two screws. Repeat this with the other two blocks and check if the lens can be switched between macro mode and normal mode by turning the macro switch gear. Repeat the above procedure if fail to switch.
10. To un-mount, reverse the above steps.

Olympus M.Zuiko 12-50mm F3.5-6.3 EZ zoom gear

Underwater Lens Zoom Gear

Mounting the lens to the camera:

When mounting the 12-50 lens with gear installed from the GH5 camera, or when removing it, the lens must be set to the “Macro” position. This slides the gear teeth forward, and allows them to clear the GH5 camera.

Compatibility:

This zoom gear, #36059, is not backward compatible with previous Micro Four Thirds cameras/housings in our lineup. If an owner of 36059 needed to convert back to the original gear design simply purchase #90167 (the original gear ring).