

## **Instruction Manual for** **Nikonos adaptor for NA-A7II**

PN# 37202

### **FOREWORD**

Thank you for your purchase of a NAUTICAM product.

At NAUTICAM, we pride ourselves in the ability to recognise the requirements of professional as well as amateur underwater photographers and fulfill them through the innovative designs of our products. We strive to achieve a high level of user-friendliness by allowing stress-free installation and easy operation of all important functions of the camera.

Each product is individually inspected and water pressure tested to ensure optimum quality.

Please read this manual carefully before using the product, this will maximise its performance as well as its lifetime.

### **WARRANTY**

All NAUTICAM Products are warranted against any material and manufacturing defects for two years from the date of purchase for consumer use. This warranty only applies to products purchased from authorised NAUTICAM dealers and does not extend beyond the original retail purchaser.

To return your product for service, please contact your regional authorized service centre(s). Please note that this warranty only applies when the product is purchased in the territory where the service centre is located.

NAUTICAM does not hold responsibility for damage, of any nature, to any equipment used with and/or placed within our products.

NAUTICAM accepts no liability for any loss of captured images or the inability to capture images even if it is due to the malfunctioning of our products.

Unauthorised modifications and/or repairs of our products will automatically invalidate the warranty.

### **IDENTIFICATION OF PARTS**

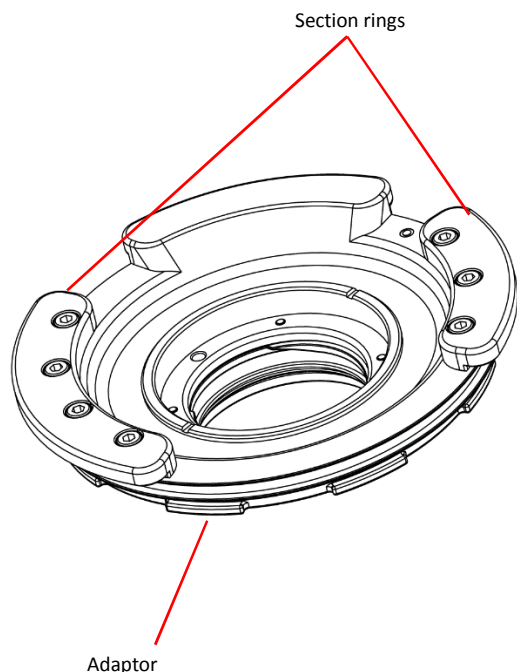

### **MOUNTING THE PORT TO A HOUSING**

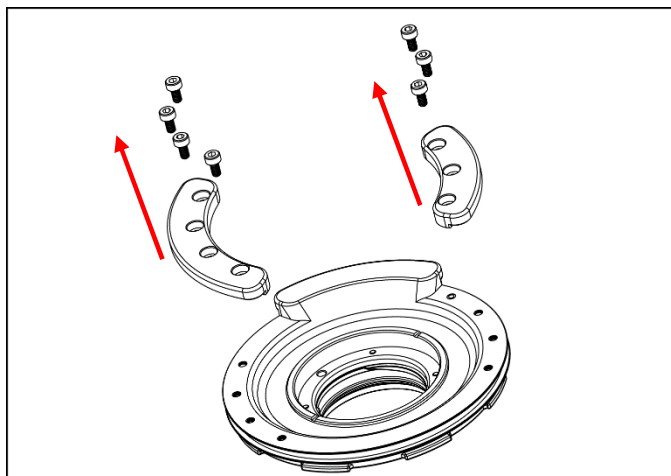

Detach the two section rings from the adaptor by removing the screws.

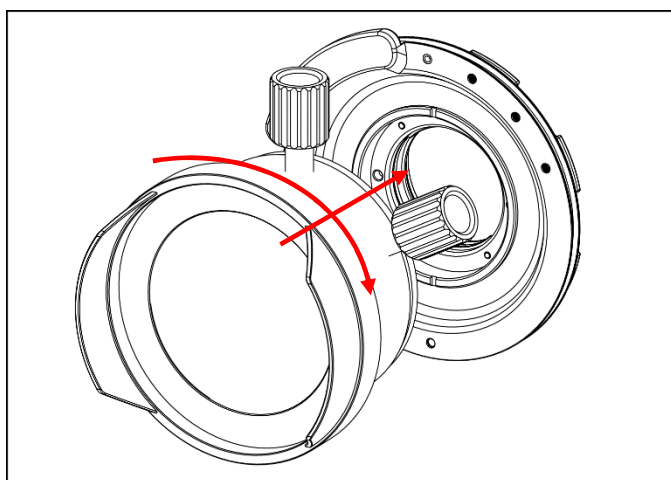

Align the focus knob of the Nikonos lens with the index mark on the adaptor and then gently pushing it into the adaptor until it cannot go in any further.

Turn the Nikonos lens clockwise for 90°.

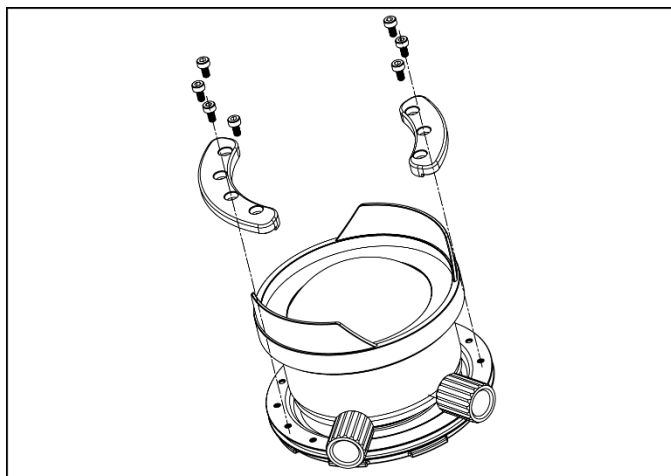

Install the two section rings back onto the adaptor and tighten it with screws.

--- continue on next page ---

--- continued from front page ---

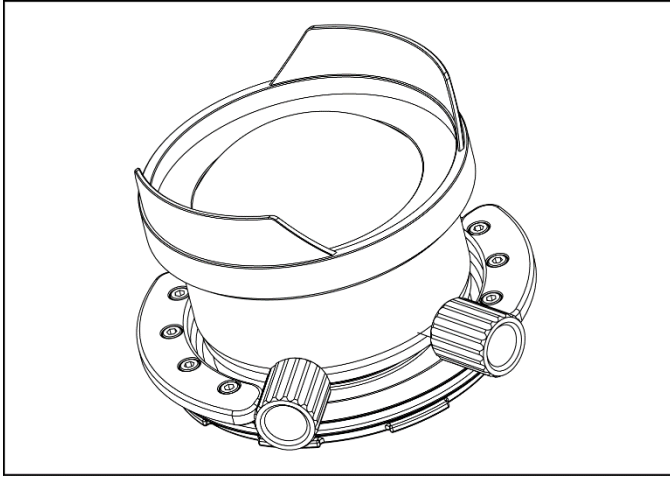

Refer to the housing manual for mount the adaptor to housing.

To remove the Nikonos lens from the adaptor, reverse the above steps.