

## 83213 M67 to Bayonet Mount Converter

### Instruction Manual

#### FOREWORD

Thank you for your purchase of a NAUTICAM product.

At NAUTICAM, we pride ourselves in the ability to recognise the requirements of professional as well as amateur underwater photographers and fulfill them through the innovative designs of our products. We strive to achieve a high level of user-friendliness by allowing stress-free installation and easy operation of all important functions of the camera.

Please read this manual carefully before using the product, this will maximise its performance as well as its lifetime.

#### WARRANTY

All NAUTICAM Products are warranted against any material and manufacturing defects for two years from the date of purchase for consumer use. This warranty only applies to products purchased from authorised NAUTICAM dealers and does not extend beyond the original retail purchaser.

To return your product for service, please contact your regional authorized service centre(s). Please note that this warranty only applies when the product is purchased in the territory where the service centre is located.

NAUTICAM does not hold responsibility for damage, of any nature, to any equipment used with and/or placed within our products.

NAUTICAM accepts no liability for any loss of captured images or the inability to capture images even if it is due to the malfunctioning of our products.

Unauthorised modifications and/or repairs of our products will automatically invalidate the warranty.

#### IDENTIFICATION OF PARTS

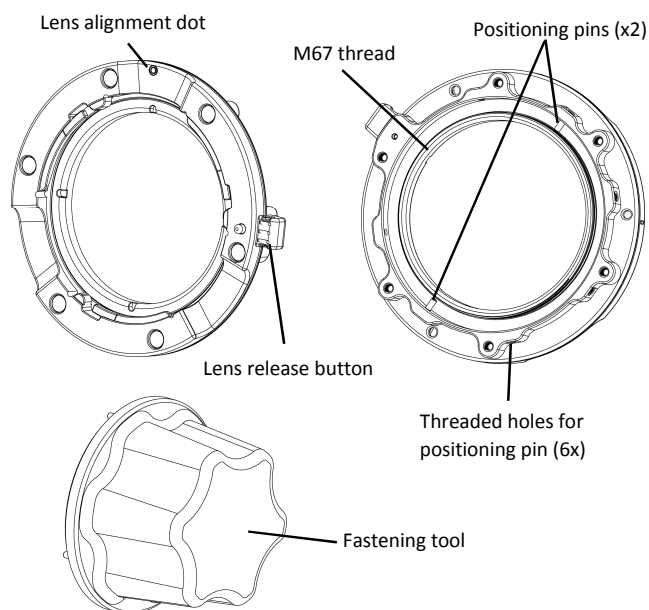

#### INSTALL TO THE PORT

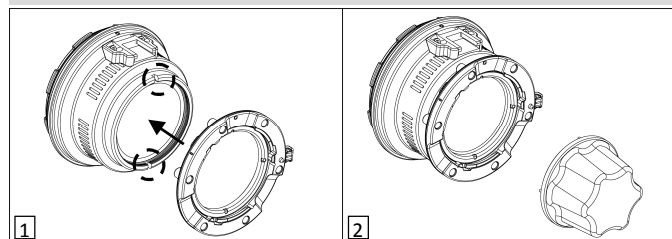

Align the two positioning pins on the back of the converter with the slots on the front of the port. Fasten the converter on the front of the port with the tool provided.

*Note: The position of the converter can be adjusted by relocating the two positioning pins into the threaded holes around the converter.*

#### MOUNTING LENS

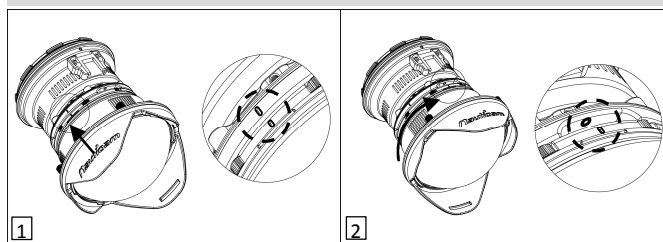

Align the "1" mark on the lens with the "1" mark on the Converter and then push it in. Turn the lens clockwise until the "1" mark on the lens aligns with the WHITE dot on the converter and a "click" sound is heard.

#### UN-MOUNTING LENS

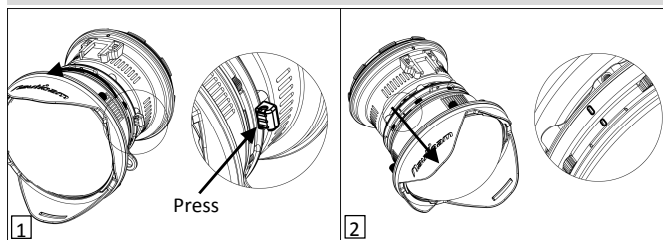

Press and hold the RED lens release button and then turn the lens anti-clockwise. Remove the lens when "1" mark on the lens aligns with the "1" mark on the converter.

#### SPECIFICATIONS

Dimensions:	Dia95.2mm x 13.4mm (exclude extruded part)
Weight:	Approx. 58g
Mount:	M67 to Nauticam bayonet mount
Compatible Lenses:	83201 Wet Wide Lens 1 (WWL-1) 83214 Bayonet Mount Adaptor for SMC/CMC